

## CYLINDER BLOCK (II) ASSEMBLY

A6E242402000E10

1. Assemble in the order indicated in the table.

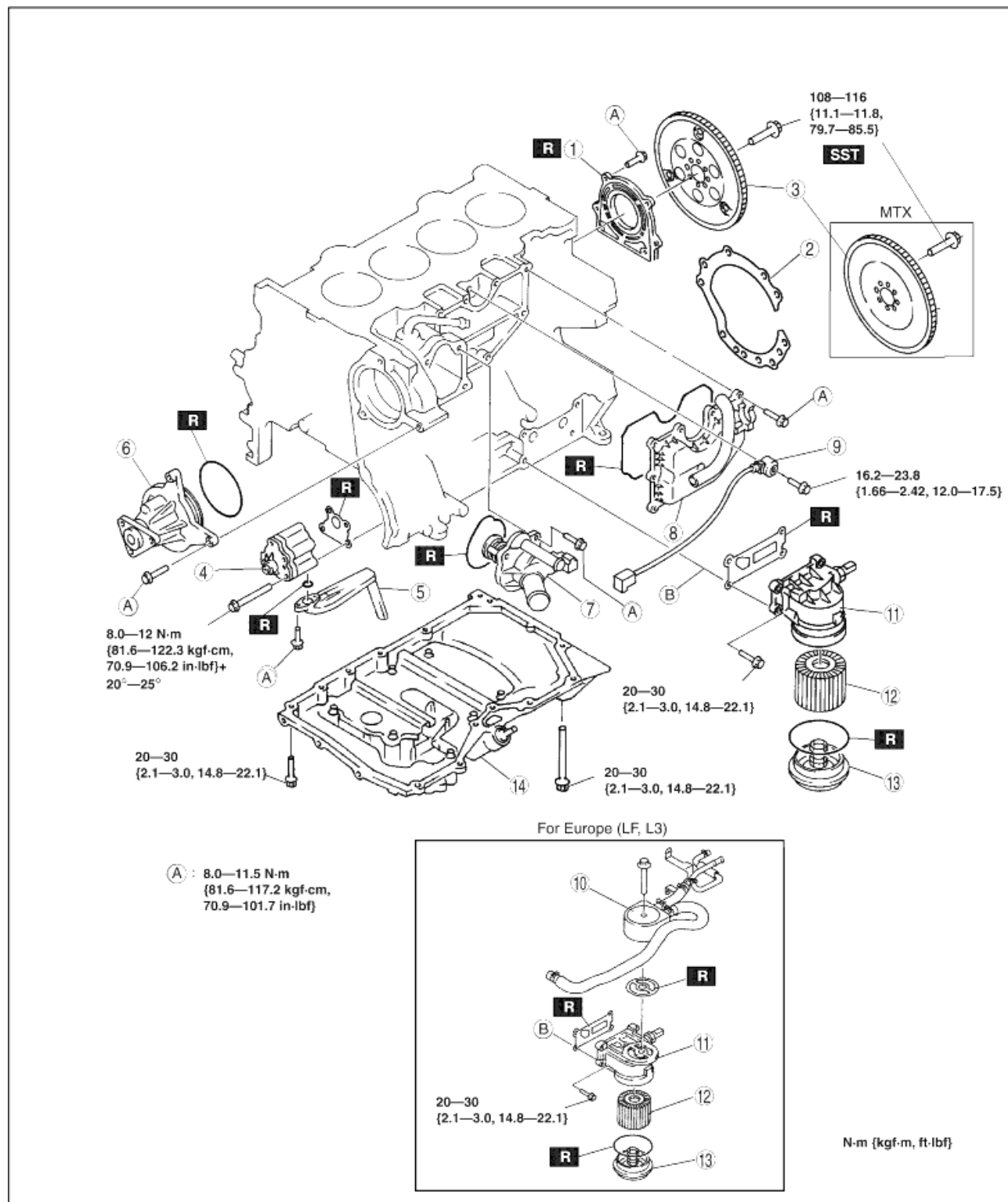

AME2224E043

1	Rear oil seal
	(See <a href="#">Rear Oil Seal Assembly Note</a> )

2	End plate (MPV)
3	Flywheel (MTX), Drive plate (ATX) (See <a href="#">Drive Plate (ATX), Flywheel (MTX) Assembly Note</a> )
4	Oil pump
5	Oil strainer
6	Water pump
7	Thermostat
8	Oil separator
9	Knock sensor
10	Oil cooler
11	Oil filter adapter
12	Oil filter
13	Oil filter cover
14	Oil pan (See <a href="#">Oil pan Assembly Note</a> )
15	MTX

### Rear Oil Seal Assembly Note

1. Apply silicone sealant to the mating faces as shown.

Dot diameter:  
4.0-6.0 mm {0.16-0.23 in}

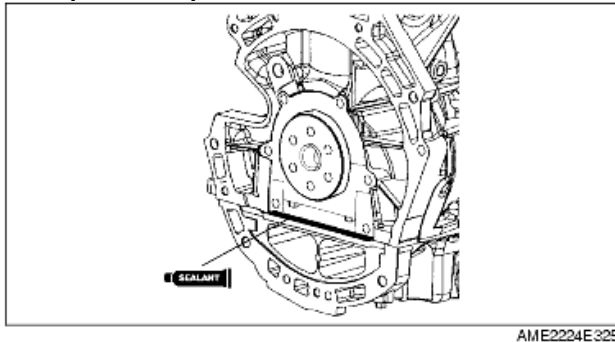

AME2224E325

2. Apply clean engine oil to the new oil seal lip.
3. Install the rear oil seal using the installer as shown.

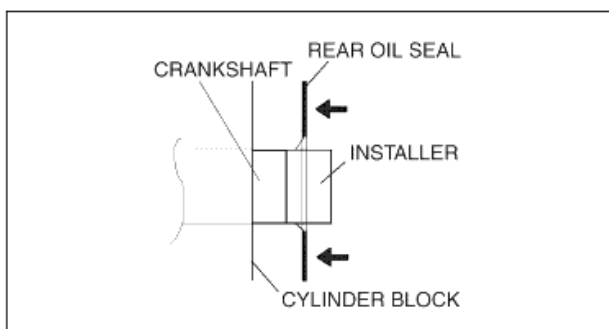

AME2224E326

4. Tighten the rear oil seal bolts in the order as shown.

Tightening torque:  
8.0-11.5 N·m {81.6-117.2 kgf·m, 70.9-101.7 in·lb}

### Drive Plate (ATX), Flywheel (MTX) Assembly Note

1. Hold the crankshaft using the **SST**.
2. Tighten the bolts in the order indicated in the figure in several passes.

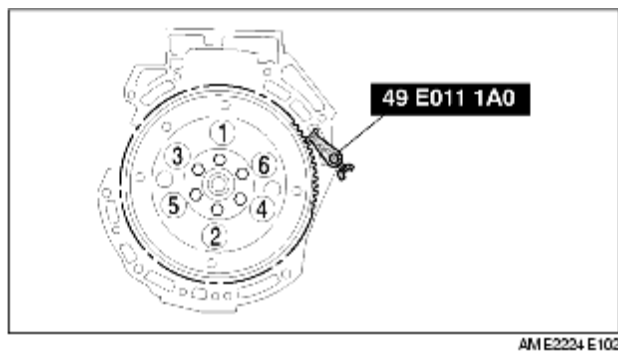

### Oil pan Assembly Note

1. Apply a continuous bead of silicone sealant to the oil pan as indicated in the figure.

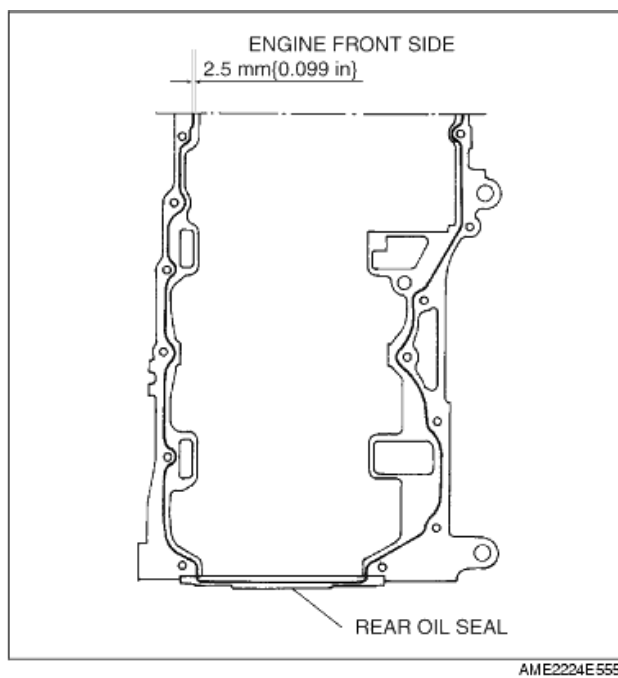

2. Use a square ruler to unite the oil pan and the cylinder block junction side on the engine front cover side.

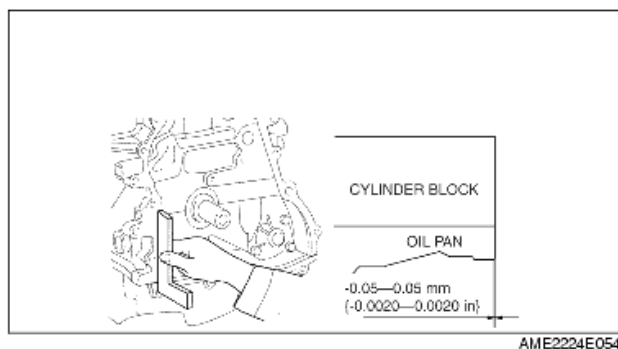

3. Tighten the rear oil pan bolts in the order as shown.

Tightening torque:  
20-30 N·m {2.1-3.0 kgf·m, 15.2-21.6 in·lbf}

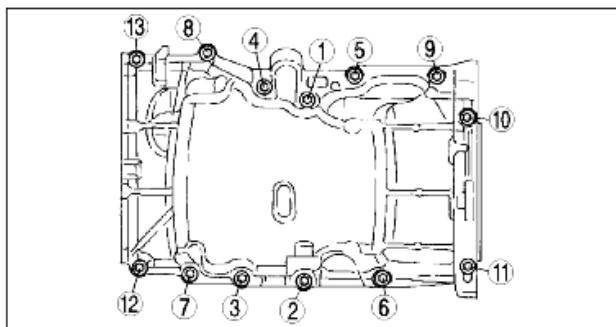

AME2224E056